

EG 1507 - Hand Powered Van de Graaff Electrostatic Machine

Assembling process

Movable bearing set with Lower roller

With a Hacksaw cut a piece of 3/4" PVC tube with 5 1/2" length, then drill a 5/64" hole 2 1/2" apart from one end and place a No. 4 x 3/8" screw on it.

Inserts a Ball bearing in the tube extremity closest to the screw until the face of the bearing touches the screw head. The PVC tube must stay tight with inner part of the Ball bearing to be held firmly on place.



Inserts the PVC tube with bearing in the hole of the plastic Movable bearing support, place the wood Bearing support over it and faster with four No. 7 x 1/4" screws with appropriate washers.

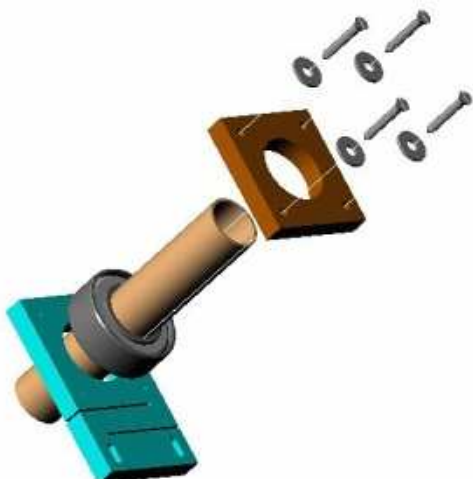

Put end Caps on the PVC tube extremities and cover the exposed PVC tube between Bearing support and PVC Cap located on longer side with Teflon tape.



Several layers of Teflon tape may be need to cover all the exposed surface, try to put the Teflon in a way that the center became thicker than the extremities, this helps maintain Transfer belt in place.

Loose the four mounting screws and adjust the ball bearing position until find a position where the PVC tube together with the bearing inner part can rotate freely, faster the four screws again.